

ZB

BRAZED HEAT EXCHANGERS FOR WALL MOUNTED BOILERS

ZB 190

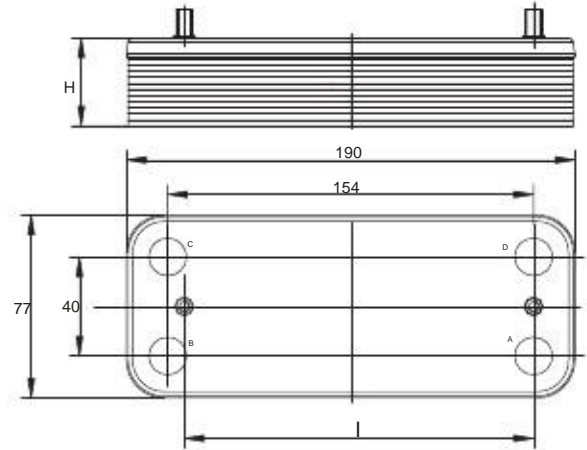

TECHNICAL FEATURES

H	mm.	8+n x 2.5	WORKING PRESSURE	bar	10	N° OF PLATES	min max	8-40
HOLES DIAMETER	mm.	16	TESTING PRESSURE	bar	13	PLATES MATERIAL	INOX 316L S.S. 316L	
I		*	SANITARY WATER CIRCUIT		A-B	BRAZING MATERIAL	CAME COPPER	
WEIGHT	gr.	127+nx55	SECONDARY CIRCUIT		C-D	SOCKETS	da 1/2" a 3/4" from 1/2" to 3/4"	

* based on customer's request

ZB 207

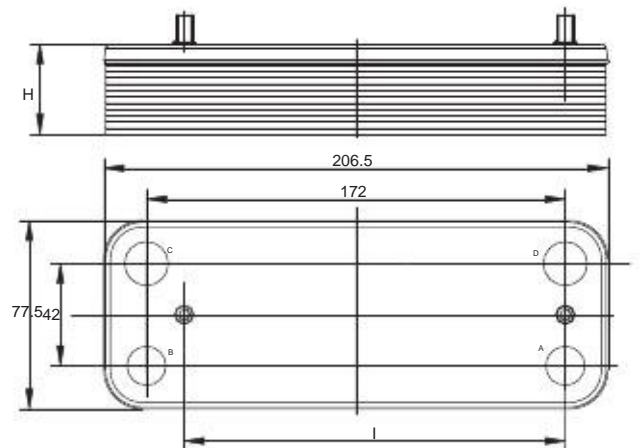

TECHNICAL FEATURES

H	mm.	7+n x 2.6	WORKING PRESSURE	bar	10	N° OF PLATES	min max	8-40
HOLES DIAMETER	mm.	16 (A-B) 18 (C-D)	TESTING PRESSURE	bar	13	PLATES MATERIAL	INOX 316L S.S. 316L	
I		*	SANITARY WATER CIRCUIT		A-B	BRAZING MATERIAL	COPPER	
WEIGHT	gr.	138+nx62	SECONDARY CIRCUIT		C-D	SOCKETS	da 1/2" a 3/4" from 1/2" to 3/4"	

* based on customer's request

ZB BRAZED HEAT EXCHANGERS FOR WALL MOUNTED BOILERS

ZB 315

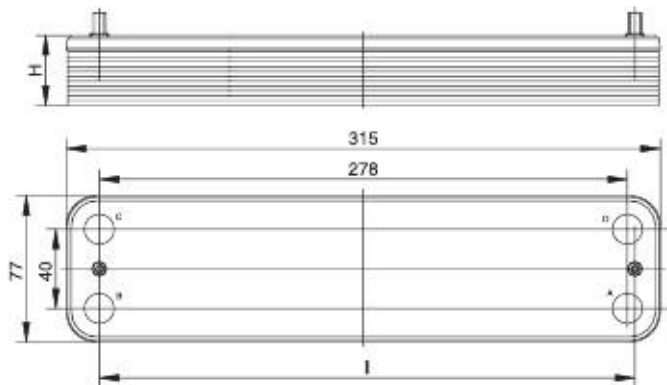

CARATTERISTICHE TECNICHE - TECHNICAL FEATURES

H	mm.	8+n x 2.5	WORKING PRESSURE	bar	10	N° OF PLATES	min max	8-40
HOLES DIAMETER	mm. mm.	16	TESTING PRESSURE	bar	13	PLATES MATERIAL	INOX 316L S.S. 316L	
l		*	SANITARY WATER CIRCUIT		A - B	BRAZING MATERIAL	COPPER	
WEIGHT	gr.	207+nx94	SECONDARY CIRCUIT		C - D	SOCKETS	da 1/2" a 3/4" from 1/2" to 3/4"	

* based on customer's request

ZB 195 CROSS FLOW

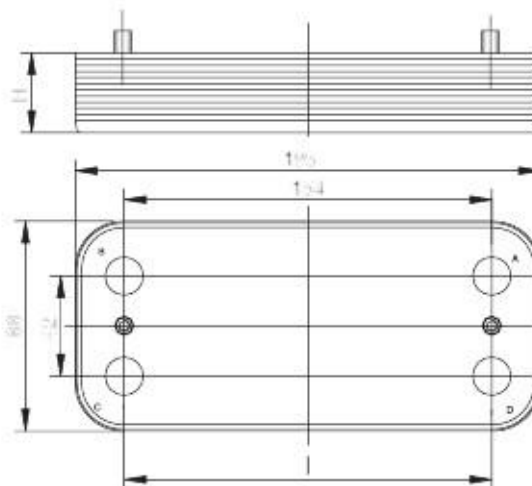

CARATTERISTICHE TECNICHE - TECHNICAL FEATURES

H	mm.	7+n x 2.6	WORKING PRESSURE	bar	10	N° OF PLATES	min max	10-40
HOLES DIAMETER	mm. mm.	14 / 16	TESTING PRESSURE	bar	13	PLATES MATERIAL	INOX 316L S.S. 316L	
l		*	SANITARY WATER CIRCUIT		A - C	BRAZING MATERIAL	COPPER	
WEIGHT	gr.	149+nx63	SECONDARY CIRCUIT		B - D	SOCKETS	da 1/2" a 3/4" from 1/2" to 3/4"	

* based on customer's request

ZB BRAZED HEAT EXCHANGERS PERFOR WALL MOUNTED BOILERS / SCALD MURALI

ZB 195 (PATENT PENDING)

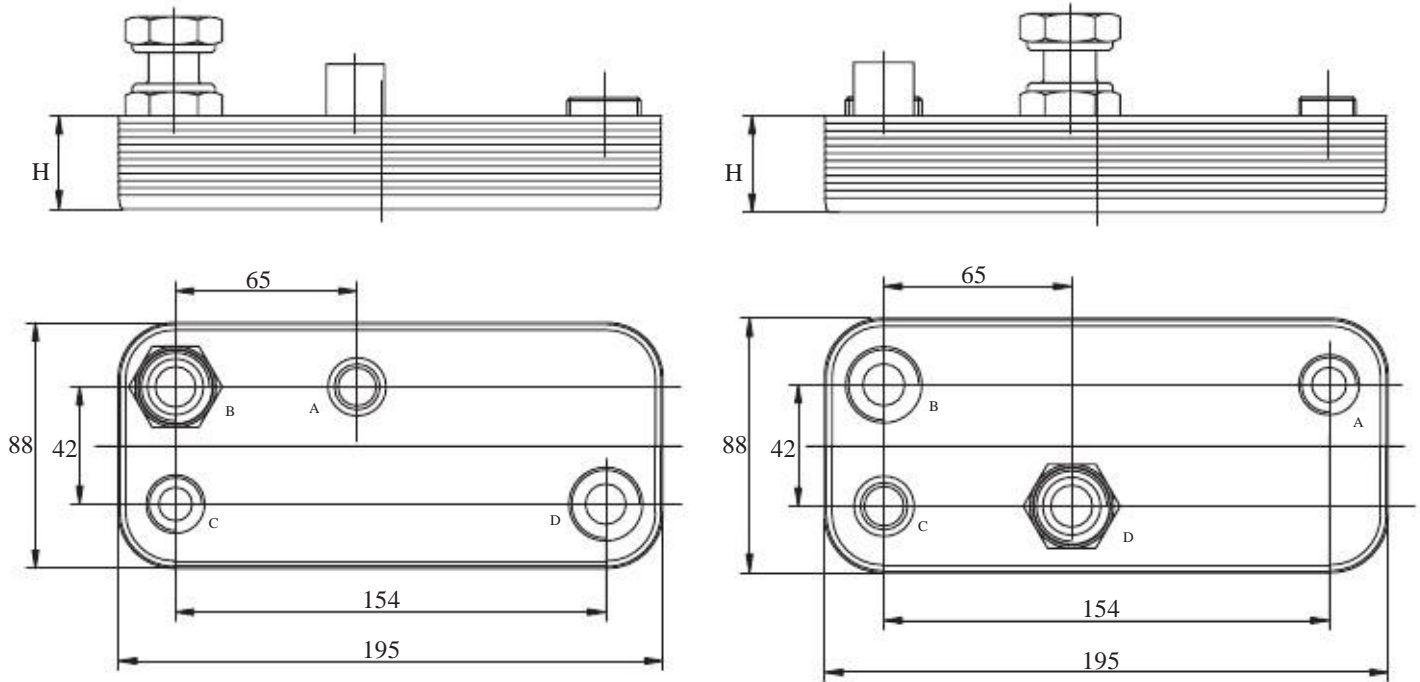

CARATTERISTICHE TECNICHE - TECHNICAL FEATURES

H	mm. 7+n x 2.6	WORKING PRESSURE	bar	10	SECONDARY CIRCUIT	B-D
PLATES MATERIAL	INOX 316L S.S. 316L	TESTING PRESSURE	bar	13	WEIGHT	gr. 149+nx63
BRAZING MATERIAL	COPPER	SANITARY WATER CIRCUIT	A-C	SOCKETS	da 1/2" a 3/4" from 1/2" to 3/4"	
* position of connections based on customer request						